

Date: January 19, 2022

When nothing is allowed to go wrong

MAPAL offers process reliability for drilling, reaming and threading operations

A lot has already happened in the production process before methods like drilling, reaming or threading are used. This makes it all the more important that tool failure doesn't lead to damage or even destruction of the almost finished part during these final machining steps. MAPAL's tools are more than just extremely reliable – they also enable high productivity. Three-edged drilling and reaming in one step are just as much a part of this as the thread milling cutter integrated into a combination tool.

MAPAL Präzisionswerkzeuge
Dr. Kress KG
Postfach 1520 | D-73405 Aalen

Contact:
Andreas Enzenbach

Phone: +49 7361 585-3683
Fax: +49 7361 585-1019
E-mail: presse@mapal.com

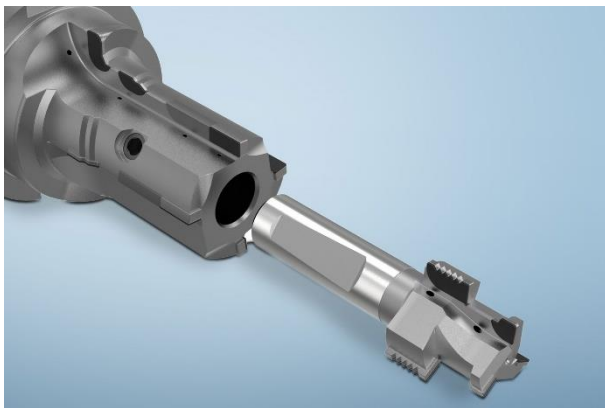

Cost-effectiveness through combination: the thread milling tool is inserted into a PCD boring tool. The part that wears out quickly is easy to replace. There's no need to recondition the entire tool. ©MAPAL

Deep bores in stainless steel are a particular challenge to process reliability because the chips produced here literally resist being transported out. Initially, they become plastically deformed, only to elastically open up again after a few millimetres, and then they tend to jam. With its high-performance drill MEGA-Speed-Drill-Inox, MAPAL has already established a solution on the market for bores of up to 5xD in stainless steels, but customers are asking for more: it should be possible up to depths of 8xD and 12xD.

Date: January 19, 2022

Three guiding chamfers for more speed

The MEGA-Speed-Drill-Inox is characterised by a special technology with three guiding chamfers. They force the drill to move orbitally, which reduces the friction on the guiding chamfers, thus allowing 40 percent higher cutting speeds than with conventional double-edged drills. High-speed technology in drilling is the tool manufacturer's answer to high-speed spindles in the machines, which reach up to 18,000 rpm and only develop their maximum torque in the higher spindle speed range. „We have taken it upon ourselves to develop a solution that can fully exploit this,“ explains Michael Villwock, Product Manager for solid carbide tools at MAPAL.

**MAPAL Präzisionswerkzeuge
Dr. Kress KG**
Postfach 1520 | D-73405 Aalen

Contact:
Andreas Enzenbach

Phone: +49 7361 585-3683
Fax: +49 7361 585-1019
E-mail: presse@mapal.com



With 8xD and 12xD in stainless steel: forced orbital movements reduce the pressure on the three guiding chamfers of the MEGA-Speed-Drill-Inox. The flute core tapers towards the back and ensures reliable chip removal. ©MAPAL

MAPAL has changed the groove profile to ensure high process reliability with this concept, even at greater drilling depths. A slot core that tapers towards the rear ensures reliable chip removal. The fine grinding of the profile effectively reduces the friction of the chips in the drill. The improvements are measurable: while competing products reach a point at drilling depths of 8xD where the torque increases extremely, the MEGA-Speed-Drill-Inox shows a consistently low torque even at 12xD. The geometry of the point thinning, the chip shaping and the cutting edge preparation, which is perfectly matched to the workpiece material, have also been modified in the new models.

Date: January 19, 2022

Drilling and reaming in one tool

The Tritan-Drill-Reamer combines drilling and reaming in one tool. The drill reamer is a good compromise when it comes to creating precision fit bores in IT7 tolerance. Eliminating the need to change tools for a second machining step shortens cycle times by a few seconds. This is particularly beneficial for users who only produce a few bores per part. The Tritan-Drill-Reamer is a further development of MAPAL's double-edged MEGA-Drill-Reamer and is based on the three-edged Tritan-Drill.

**MAPAL Präzisionswerkzeuge
Dr. Kress KG**
Postfach 1520 | D-73405 Aalen

Contact:
Andreas Enzenbach

Phone: +49 7361 585-3683
Fax: +49 7361 585-1019
E-mail: presse@mapal.com



Drilling and reaming in one go: with a self-centring chisel edge and six guiding chamfers, the Tritan-Drill-Reamer with three cutting edges offers maximum process reliability with a variety of application parameters. ©MAPAL

Tangled chips, which are drawn into the secondary flute, wrap around the tool and destroy the part, are an absolute nightmare for the user. With its three-flute solution, MAPAL has been able to eliminate this problem and ensures high process reliability even with long-chipping steel materials. For the combination tool, the drill with three cutting edges was supplemented by three further guiding chamfers. Together with these six guiding chamfers, the self-centring chisel edge ensures that the drill reamer is very insensitive to different application parameters and always offers the highest process capability. The tip looks like a small star and has a screw face grinding with a chisel edge. It guarantees the highest positioning accuracy of the tool.

Date: January 19, 2022

With the help of its test series, MAPAL's Research and Development proves that changes in the cutting values cause hardly any deviations in the bore diameters. This saves time-consuming searches for the right cutting parameters during manufacturing, which reduces the setup effort and leads to faster results. The roundness also remained constant over hundreds of test bores.

MAPAL offers the Tritan-Drill-Reamer for dia-meters from 4 to 20 mm in lengths of 3xD and 5xD with internal cooling. Diameters in 1/100 intervals are also available for producing a wide range of fits with the drill reamer with high precision as well as achieving further IT7 tolerances.

PCD thread milling cutter piggybacking along

Custom tools customised for a specific application guarantee compliance not only with tight shape and position tolerances on the part, but also enable short cycle times. When these combination tools are used, it makes sense to throw in a useful tool at the same time: a PCD thread milling cutter.



The range of solutions for PCD thread milling is wide: from deep threads with long cutting edges and different numbers of teeth to stable combination tools and thread milling cutters with individual cooling concept with minimum quantity lubrication to the simple, cost-effective tool solution. ©MAPAL

**MAPAL Präzisionswerkzeuge
Dr. Kress KG**
Postfach 1520 | D-73405 Aalen

Contact:
Andreas Enzenbach

Phone: +49 7361 585-3683
Fax: +49 7361 585-1019
E-mail: presse@mapal.com

Date: January 19, 2022

There is no need to use the additional tool component for the same work step. For example, a custom tool can be designed primarily for boring and applying a chamfer, and the thread is created at a completely different location on the part. With one tool change eliminated, the cycle time is shortened. „We always spring into action when a very large number of threads need to be produced cost-effectively or high precision is required, “ says Matthias Fuchs, Product Specialist for PCD tools at MAPAL.

MAPAL Präzisionswerkzeuge
Dr. Kress KG
Postfach 1520 | D-73405 Aalen

Contact:
Andreas Enzenbach

Phone: +49 7361 585-3683
Fax: +49 7361 585-1019
E-mail: presse@mapal.com

The change from a solid carbide cutting edge to polycrystalline diamond as the cutting material can bring different advantages. The PCD thread milling cutter has a significantly longer tool life, enables longer dimensional accuracy of tolerances, such as the flank angle, with higher cutting values, and maintains the required surface qualities. MAPAL demonstrates how this works in practice with a large number of hands-on examples. Compared to a solid carbide tool, the cutting values for thread milling in a cylinder head could be increased by 30 percent. In the manufacturing of brass flow metres, the cycle time was reduced by 40 percent compared to solid carbide. A PCD thread milling cutter finishes M12x1 fine threads in highly hardened and tempered forged aluminium for a common rail flange with a tool life of around 85,000 threads.

In automated assembly lines, a burr-free and bevelled thread increases process reliability during assembly. There is also the option of integrating a deburring cutter, which saves the extra machining step of deburring.

Another advantage is that users have to reset the tool much less frequently. With solid carbide tools, the shape of the threads produced changes with increasing wear and tear, which requires corrections in the machine

PRESS RELEASE



Date: January 19, 2022

control. In the production of an M12 thread for a customer, the tool life advantage of the PCD thread milling cutter is clearly demonstrated: while it reaches a life of 120,000 parts, its solid carbide counterpart reaches only 14,000 in comparison. To achieve these quantities, the solid carbide thread milling cutter required four radius corrections of 50 µm each, while the PCD thread milling cutter only needed one adjustment of 5 µm.

MAPAL Präzisionswerkzeuge
Dr. Kress KG
Postfach 1520 | D-73405 Aalen

Contact:
Andreas Enzenbach

Phone: +49 7361 585-3683
Fax: +49 7361 585-1019
E-mail: presse@mapal.com

As an alternative technology, the tap drill produces the thread in a single step, while the thread milling cutter first requires a core bore. Nonetheless, when threading in large-scale manufacturing, milling is preferred for reasons of process reliability, to prevent problems with tool breakage or chip removal. In the end, you have to make sure nothing else goes wrong.

Words:	1,318
Characters with spaces:	8,340

If published, please send a voucher copy by mail to Kathrin Rehor
or by e-mail to kathrin.rehor@mapal.com.